

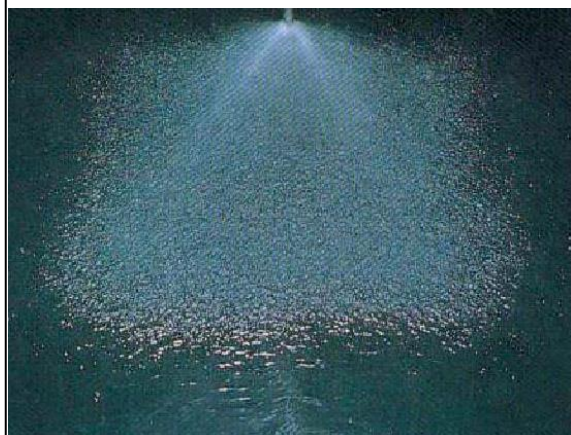

Square Full Cone Spray Nozzles

SSRP-HV series



FEATURES

- Provides stable and uniform spray distribution at low flow rate.
- Made of high chemical resistant PVDF.

APPLICATIONS

- Etching in PCB, LCD, electronics production
- Spraying chemicals in pickling line

DRAWINGS

Pipe conn. size R1/8

■ Mass: 1.7 g

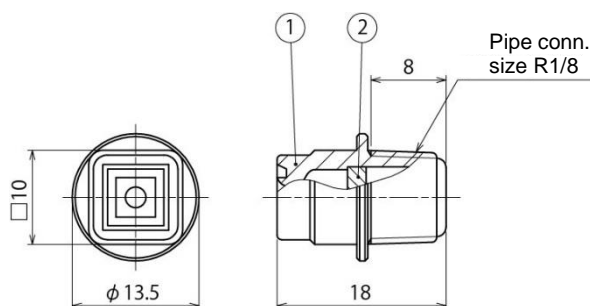

Pipe conn. size R1/4

■ Mass: 2.6 g

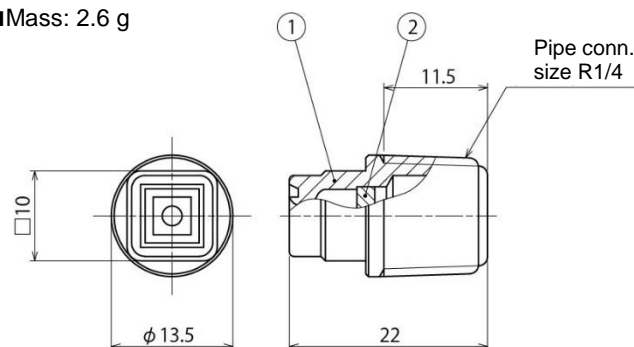

(1) Nozzle body (2) Whirler ■ Material: PVDF (Polyvinylidene fluoride)

PERFORMANCE DATA

Spray capacity code	Spray angle (°)			Spray capacity (L/min)								Mean droplet diameter (μm)	Free passage diameter (mm)
	0.05 MPa	0.2 MPa	0.5 MPa	0.05 MPa	0.1 MPa	0.15 MPa	0.2 MPa	0.3 MPa	0.5 MPa	0.7 MPa	1 MPa		
015	110	115	114	0.79	1.09	1.31	1.50	1.78	2.22	2.56	2.98	320	0.7
025	110	115	114	1.32	1.82	2.19	2.50	2.97	3.69	4.26	4.96	380	0.9

HOW TO ORDER

Please inquire or order for a specific nozzle using this coding system.

Example) 1/4M SSRP 025 HV PVDF

1/4M

SSRP

025

HV

PVDF

Pipe conn. size

Spray capacity code

1/8M or 1/4M

015 or 025

**"M" indicates male thread ("R" of the ISO standard) and "F" indicates female thread ("Rc" of the ISO standard), e.g. 1/4M = R1/4.

Please feel free to send any inquiry, request for information or quote on this product to the contacts below.



"The Fog Engineers"

H. IKEUCHI & Co., LTD.

Headquarters

Daiichi Kyogyo Bldg., 1-15-15, Awaza, Nishi-ku, Osaka 550-0011, Japan

Tel: 81-6-6538-4015 Fax: 81-6-6538-4022

Email: overseas@kirinoikeuchi.co.jp

We have our branches and affiliate companies around the world—in China, USA, The Netherlands, Thailand, Indonesia, UAE, and more. Please see our website for the nearest contact.

<https://www.kirinoikeuchi.co.jp/eng/company/location/>